

COHEN & ASSOCIATES P/L

SURVEYORS PLANNERS & MAPPING CONSULTANTS
 ABN 70 889 298 535

103 CAMERON STREET
 PO BOX 990 LAUNCESTON 7250 TAS
 TELEPHONE : 03 6331 4633

www.surveyingtas.com.au
 EMAIL : admin@surveyingtas.com.au

PLAN OF SUBDIVISION

REF: **27/74
 (6694)**

Municipality: **FLINDERS COUNCIL**
 Site Address: **LACKRANA ROAD, MEMANA**
 Tasmap Sheet: **5856 (LEVENTHORPE)**
 Grid Reference: **E: 597100 N: 5571700 (MGA)**

Owners: **D.A. & P.M. CONN**
 Title Refs: **241033-35**
 Dates: **Version A: 3-10-13
 Version B:**
 Scale: **1 : 15000 @ A3**

DISCLAIMER: This is a preliminary plan prepared without field survey and forms part of an application to subdivide the land described and is not to be used for any other purpose. Contours and levels may be transcribed from other sources and their accuracy has not been verified. These should not be used. The dimensions, area, location of improvements and number of lots are approximate and may vary as a result of decisions by the Municipality, Land Use Planning Review Panel, engineering or other advice. Easements may not be shown as these are to be determined at the time of survey. The plan is not to be copied unless this note is included.

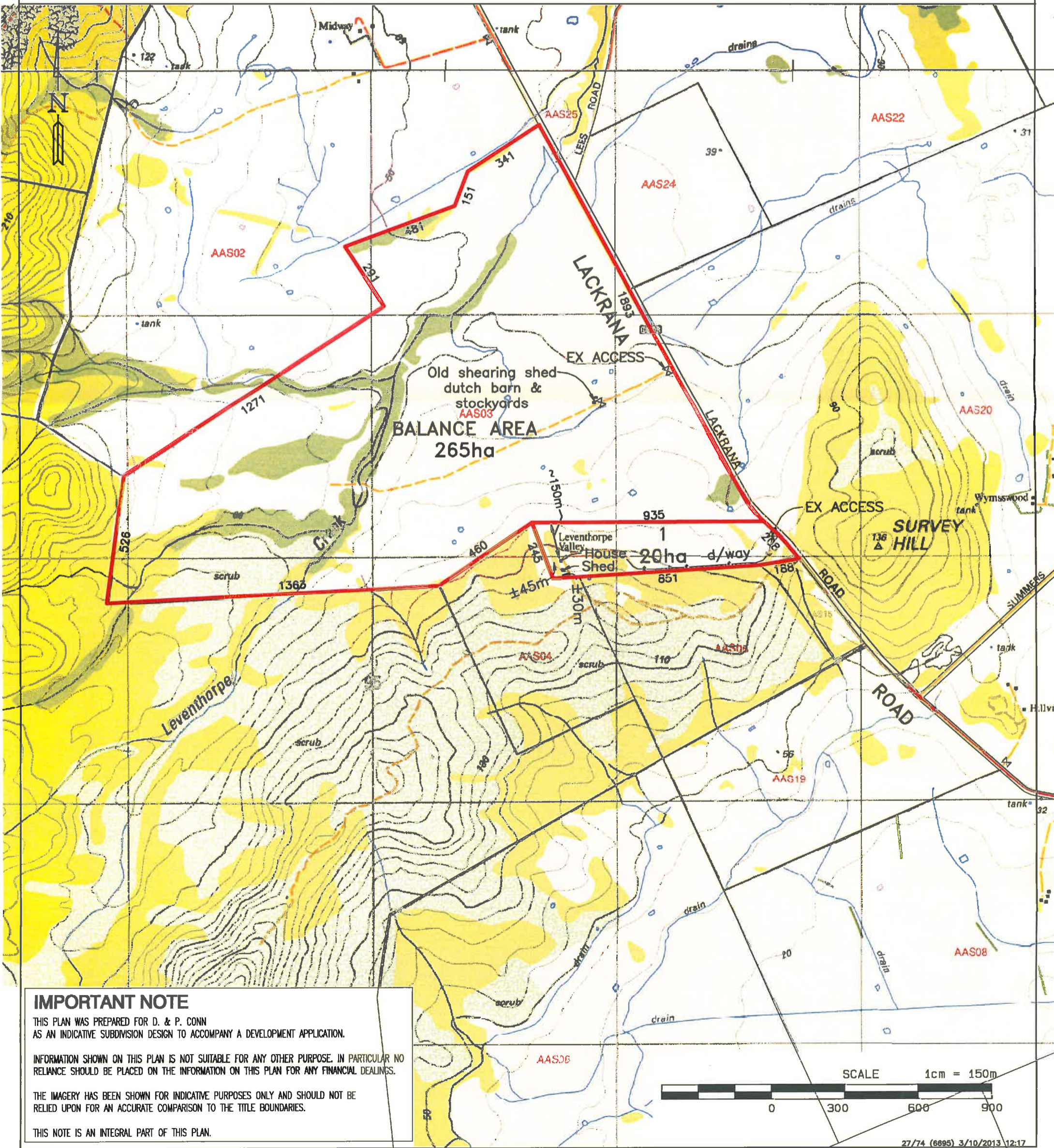

IMPORTANT NOTE
 THIS PLAN WAS PREPARED FOR D. & P. CONN
 AS AN INDICATIVE SUBDIVISION DESIGN TO ACCOMPANY A DEVELOPMENT APPLICATION.
 INFORMATION SHOWN ON THIS PLAN IS NOT SUITABLE FOR ANY OTHER PURPOSE. IN PARTICULAR NO
 RELIANCE SHOULD BE PLACED ON THE INFORMATION ON THIS PLAN FOR ANY FINANCIAL DEALINGS.
 THE IMAGERY HAS BEEN SHOWN FOR INDICATIVE PURPOSES ONLY AND SHOULD NOT BE
 RELIED UPON FOR AN ACCURATE COMPARISON TO THE TITLE BOUNDARIES.
 THIS NOTE IS AN INTEGRAL PART OF THIS PLAN.

